

IOWA DEPARTMENT OF NATURAL RESOURCES

CONSTRUCTION DOCUMENTS

FOR

BIG CREEK STATE PARK

JETTY REPAIRS

POLK COUNTY, IOWA

PROJECT #18-02-77-01

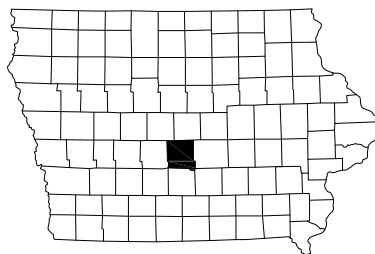

SHEET INDEX

1	COVER SHEET
2	PROJECT LOCATION
3	ESTIMATED QUANTITIES AND GENERAL NOTES
4	SITE PLAN
5	DETAILS
6	DOCK ABUTMENT DETAILS
7	DOCK ABUTMENT DETAILS

CONSULTANT:

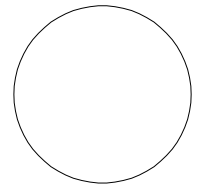

IOWA DEPARTMENT OF
NATURAL RESOURCES

ENGINEERING SERVICES - WALLACE BUILDING
502 E. 9TH ST., DES MOINES, IA 50319-0034



COVER SHEET

JETTY REPAIRS CONSTRUCTION FOR:

BIG CREEK STATE PARK

POLK COUNTY, IA

DIRECTORY

PROJECT MANAGER		CONSTRUCTION INSPECTOR	
COMPANY	IOWA DEPARTMENT OF NATURAL RESOURCES	COMPANY	IOWA DEPARTMENT OF NATURAL RESOURCES
ADDRESS	305 SOUTH OAK ST	ADDRESS	305 SOUTH OAK ST
CITY, STATE, ZIP	JEFFERSON, IA 50129	CITY, STATE, ZIP	JEFFERSON, IA 50129
CONTACT	DON LABATE	CONTACT	DON LABATE
TELEPHONE	515-250-3714	TELEPHONE	515-250-3714
FAX		FAX	
EMAIL	Don.Labate@dnr.iowa.gov	EMAIL	Don.Labate@dnr.iowa.gov

PROJECT DESCRIPTION

THIS PROJECT INVOLVES ARMORING DETERIORATED JETTIES WITH CLASS 'E' REVETMENT AND OTHER INCIDENTAL WORK AS REQUIRED BY D.N.R. CONSTRUCTION INSPECTOR IN POLK COUNTY, IOWA.

AUTHORIZATION TO BID

AUTHORIZATION - PARKS | WILDLIFE | FISHERIES | LAW ENFORCEMENT | FORESTRY

ENGINEERING BUREAU CHIEF

DATE

NO. BY DATE REVISION

DRWN BY: ES PROJECT NUMBER: 18-02-77-01
CHK'D BY: D.L. DATE: FEB/2018

SHEET No:

1

PROJECT LOCATION

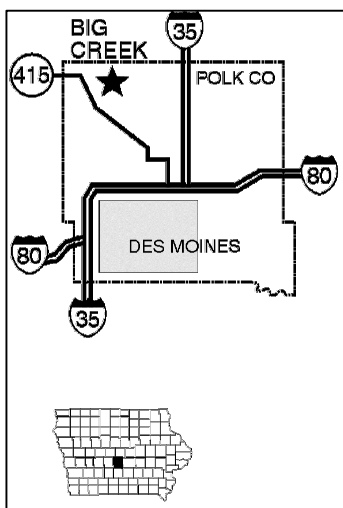
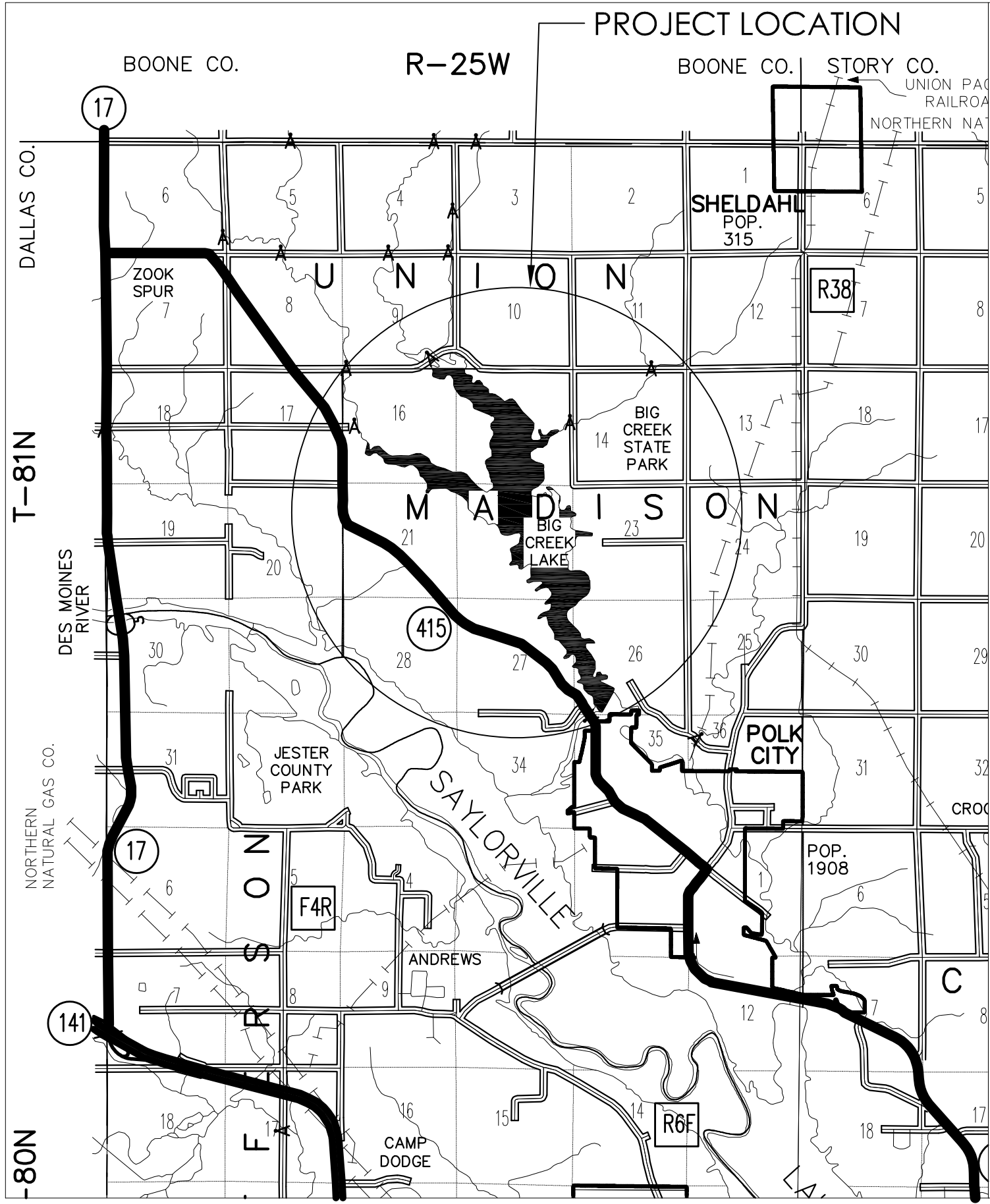

A SHELTER NAMES

- A ATLANTIC
- B BEVERLY DINGHY
- C CADET
- D DUSTER
- E ENSIGN
- F FIREFLY
- G GANNET
- H HAMPTON
- I INLAND
- J JOLLYBOAT

- PARK RANGER
- PARK OFFICE
- PARK ATTENDANT
- INFORMATION
- PICNIC AREA - BROWN TABLES - HANDICAP ACCESSIBLE
- REST ROOM
- SHELTER
- CONCESSION - BOAT RENTAL
- PLAY & GAME FIELDS
- PHONE
- BOAT RAMP
- FISH ATTRACTOR
- FISH CLEANING STATION
- SNOWMOBILE TRAIL
- MULTI-USE TRAIL
HIKING
BIKING
CROSS COUNTRY SKIING

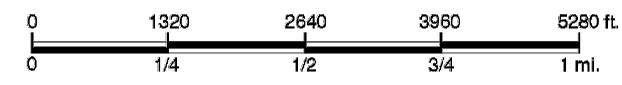
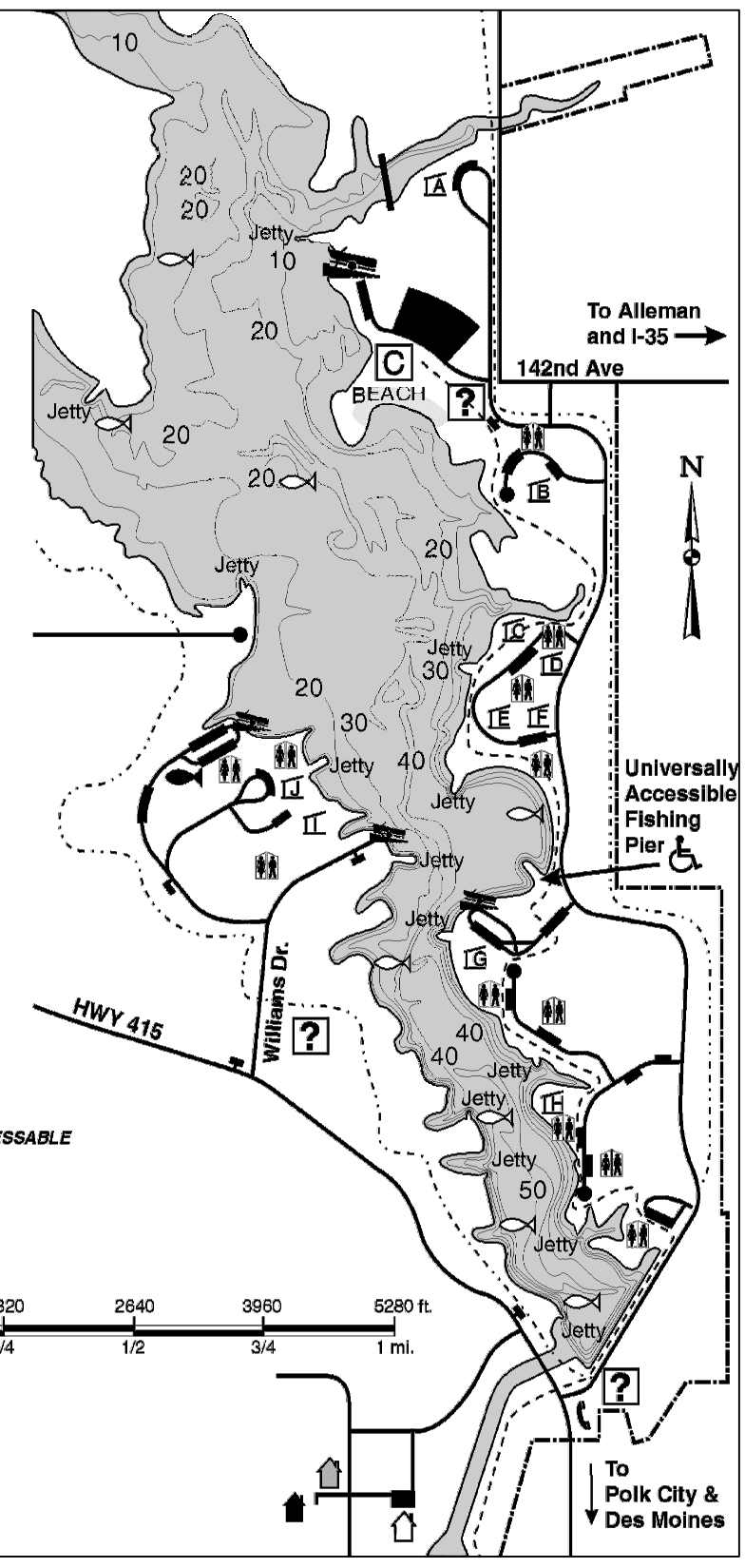
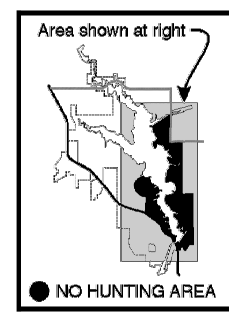

CONSULTANT:

IOWA DEPARTMENT OF
NATURAL RESOURCES

ENGINEERING SERVICES - WALLACE BUILDING
502 E. 9TH ST., DES MOINES, IA 50319-0034



PROJECT LOCATION

JETTY REPAIRS CONSTRUCTION FOR:

BIG CREEK STATE PARK

POLK COUNTY, IA

NO. BY DATE REVISION

DRAWN BY: PROJECT NUMBER:
E.S. 18-02-77-01
CHK'D BY: DATE:
B.D. FEB/2018
SHEET No. 2

ESTIMATED PROJECT QUANTITIES

ITEM	DESCRIPTION	UNIT	TOTAL
1	MOBILIZATION	L.S	1
2	CLASS 'E' REVETMENT	TONS	2,337
3	MACADAM STONE	TONS	149
4	CLASS 'A' CRUSHED STONE	TONS	161
5	DOCK ABUTMENTS	EACH	3
6	SEEDING & SITE RESTORATION	L.S	1

GENERAL NOTES:

The contractor shall notify the following two weeks prior to construction:

1. District Inspector:
DON LABATE
(515)-250-3714

2. Project Manager:
EMMANUEL SANG
(515)-321-7005

The contractor shall verify actual locations and elevations with the D.N.R Inspector.
All work shall conform to and be performed in accordance with all applicable codes and ordinances.
The contractor shall visit the site and inspect the project area and thoroughly familiarize themselves with the actual job conditions prior to the start of work. Failure to visit the project site shall not relieve the contractor from performing the work in accordance to the plans, specifications, special provisions and contract.
The contractor shall verify, at the site, all dimensions and conditions shown on the plans and shall notify the D.N.R Inspector of any discrepancies, omissions and/or conflicts prior to proceeding with the work.
The contractor is responsible for disposal for excess material (excavated material or broken concrete) which is not desirable to be incorporated into the work involved on this project. No payment for overhaul will be allowed for material hauled to these sites. No material shall be placed within the right-of-way, unless specifically stated in the plans or approved by the D.N.R Inspector.
The contractor shall not disturb desirable grass areas and desirable trees outside construction limits. The contractor will not be permitted to park or service vehicles and equipment or use these areas for storage of materials. Storage, parking and service areas will be subject to the approval of the D.N.R inspector.
The contractor is expected to have materials, equipment and labor available on a daily basis to install and maintain erosion control features on the project.
The contractor shall be responsible for any damage to existing facilities resulting from their negligence, or that of a subcontractor, and said repairs shall be approved by the owner.

ESTIMATED REFERENCE INFORMATION

ITEM	DESCRIPTION
2	CLASS 'E' REVETMENT - BID ITEM INCLUDE SHAPING & PLACING REVETMENT ON THE SIDES OF THE JETTIES AS SHOWN ON THESE PLANS. THE REVETMENT SHALL MEET IOWA D.O.T STANDARD SPECIFICATIONS OF HIGHWAY AND BRIDGE SECTION 4130 SERIES 2015 PLUS CURRENT SUPPLEMENTAL SPECIFICATION AND SPECIAL PROVISION.
3	MACADAM STONE - THIS BID ITEM IS FOR SUPPLY, PLACING AND COMPACTING MACADAM STONE ON THE FRONT OF THE JETTIES AS SHOWN ON THIS PLANS. THE STONE SHALL MEET IOWA DOT STANDARD SPECIFICATION 4122 SERIES 2015 PLUS CURRENT SUPPLEMENTAL SPECIFICATION AND SPECIAL PROVISION.
4	CLASS 'A' STONE - BID ITEM IS FOR SUPPLY, PLACING AND COMPACTING OF CLASS 'A' CRUSHED STONE ON THE TOP OF THE JETTIES AS SHOWN ON THESE PLANS. THE MATERIAL SHALL MEET THE SHALL MEET IOWA D.O.T STANDARD SPECIFICATIONS OF HIGHWAY AND BRIDGE SECTION 4120 SERIES 2015 PLUS CURRENT SUPPLEMENTAL SPECIFICATION AND SPECIAL PROVISION.
5	DOCK ABUTMENTS - BID ITEM IS FOR FABRICATION AND PLACING OF CONCRETE ABUTMENTS AS SHOWN ON SHEET 5 & 6 . PLACEMENT OF AS DIRECTED BY THE DNR FIELD ENGINEER
6	SEEDING & SITE RESTORATION - BID ITEM INCLUDE EQUIPMENT, MATERIAL AND LABOR REQUIRED TO LEVEL AND PREPARE TOPSOIL FOR SEEDING AND MULCHING IN ALL DISTURBED AREAS. SEED MIXTURE ACCORDING TO SPECIFICATIONS OR OTHERWISE AS DIRECTED BY THE D.N.R FIELD ENGINEER.

CONSTRUCTION NOTE:

DESCRIPTION
CLEARING & GRUBBING - CLEARING AND GRUBBING OF SHRUBS SHALL BE CONSIDERED INCIDENTAL TO PLACING OF RIP RAP AND THE CONTRACTOR SHALL NOT BILL D.N.R FOR THE INCIDENTAL WORK.

AREA.	RIPRAP(TONS)	CLASS 'A' (TONS)	MACADAM STONE(TONS)
HAMPTON SOUTH	558	60	
ENSIGN SOUTH	435	18	
ENSIGN NORTH	60	8	8
RANGER COVE	547	30	3
146TH	80	6	7
Y ROAD	162	12	2
NORTH JOLLY	55	6	46
SOUTH JOLLY	32	5	25
INLAND CAT	150	6	37
WILLIAM DRIVE	207	8	1
BRIDGE POINT	51	2	20

CONSULTANT:

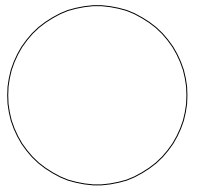

IOWA DEPARTMENT OF
NATURAL RESOURCES

ENGINEERING SERVICES - WALLACE BUILDING
502 E. 9TH ST., DES MOINES, IA 50319-0034



ESTIMATED QUANTITIES

JETTIES REPAIR CONSTRUCTION:

BIG CREEK STATE PARK

POLK COUNTY, IA

NO.	BY DATE	REVISION

DRAWN BY: ES
PROJECT NUMBER: 18-02-77-01
CHK'D BY: DL
DATE: FEB/2018

SHEET No:

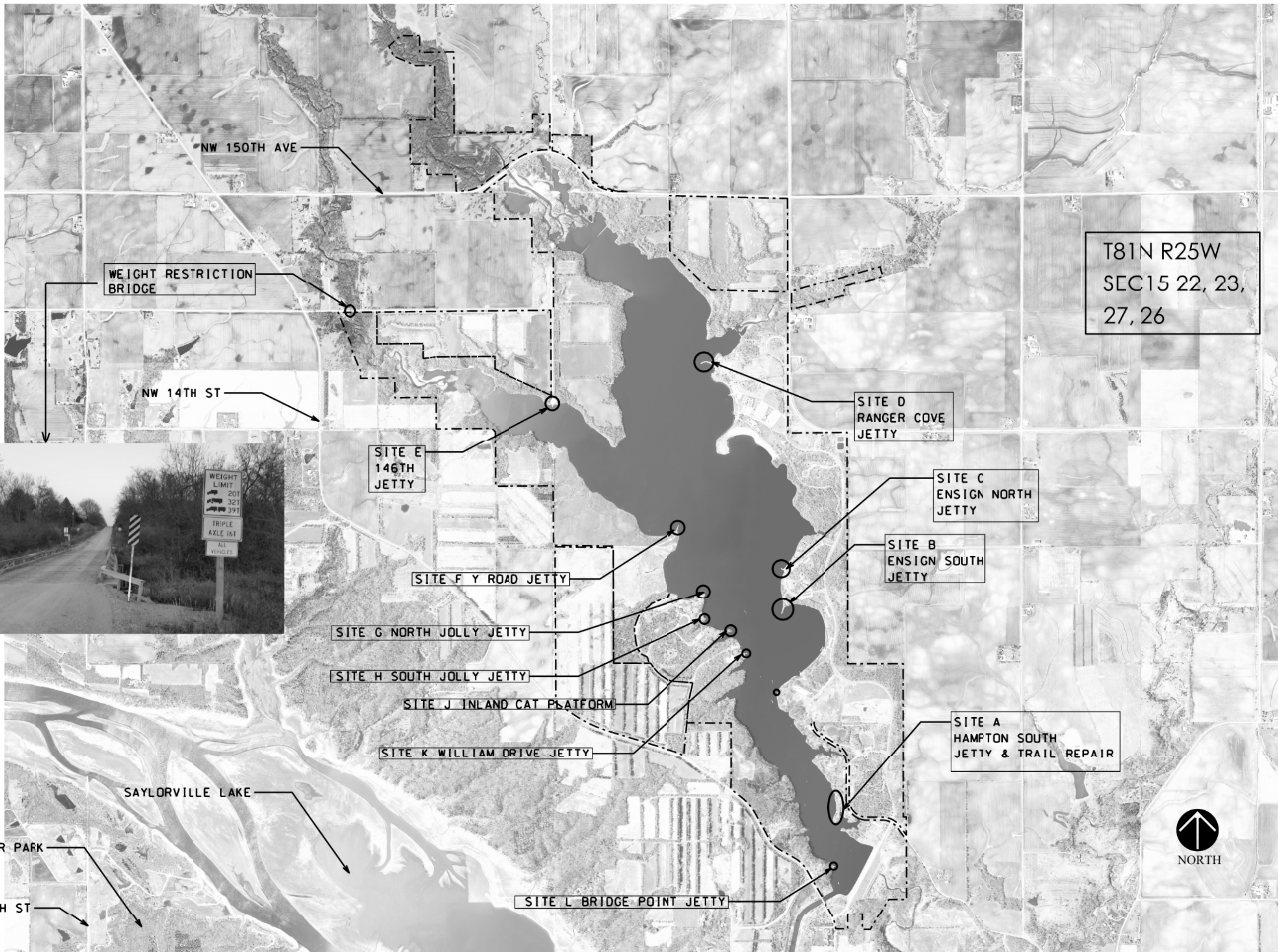

CONSULTANT:

IOWA DEPARTMENT OF
 NATURAL RESOURCES

ENGINEERING SERVICES - WALLACE BUILDING
 502 E. 9TH ST., DES MOINES, IA 50319-0034



SITE PLAN

JETTY RESTORATION FOR:

BIG CREEK STATE PARK

POLK COUNTY, IA

NO.	BY	REVISION

DRAWN BY: ES PROJECT NUMBER: 18-02-77-01
 CHKD BY: HD DATE: FEB/2018
 SHEET No: 4



NORTH

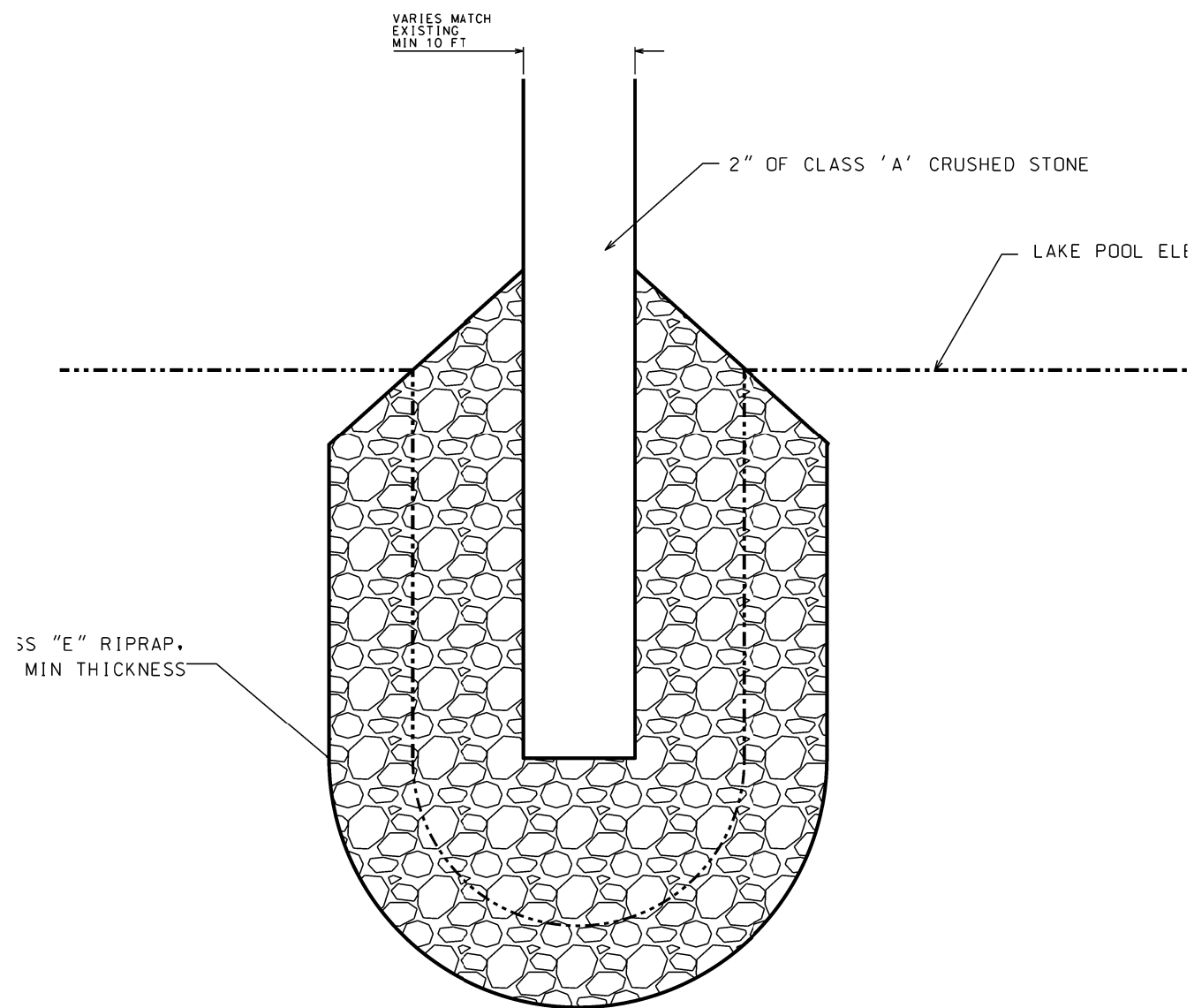

TYPICAL JETTY PLAN
NOT TO SCALE

PROPOSED JETTY REPAIR
 THE CONTRACTOR SHALL PLACE MACADAM STONE TO RAISE AND WIDEN THE END OF THE JETTY. EXISTING SURFACING MATERIAL SHALL BE PUSHED AND LEVELED OVER THE NEW MACADAM TO CHOKE THE VOIDS AND PROVIDE GENERAL LEVELING OF THE JETTY. EXISTING RIP-RAP IN THE WATER SHALL BE PULLED UP TO THE SLOPE AND AREAS THAT ARE THICK SHALL BE THINNED AND PLACED IN OTHER AREAS THAT ARE CURRENTLY THIN SO THAT IT WILL BE MOSTLY COVERED WITH THE NEW REVETMENT. PLACE CLASS "E" REVETMENT (RIPRAP) ON SIDE SLOPE AT 2:1. PLACE CLASS "A" SURFACING STONE ON THE TOP OF JETTY. TOP SHALL BE A MIN OF 10' WIDE AND GRADED WITH 2% CROSS SLOPE FOR DRAINAGE.

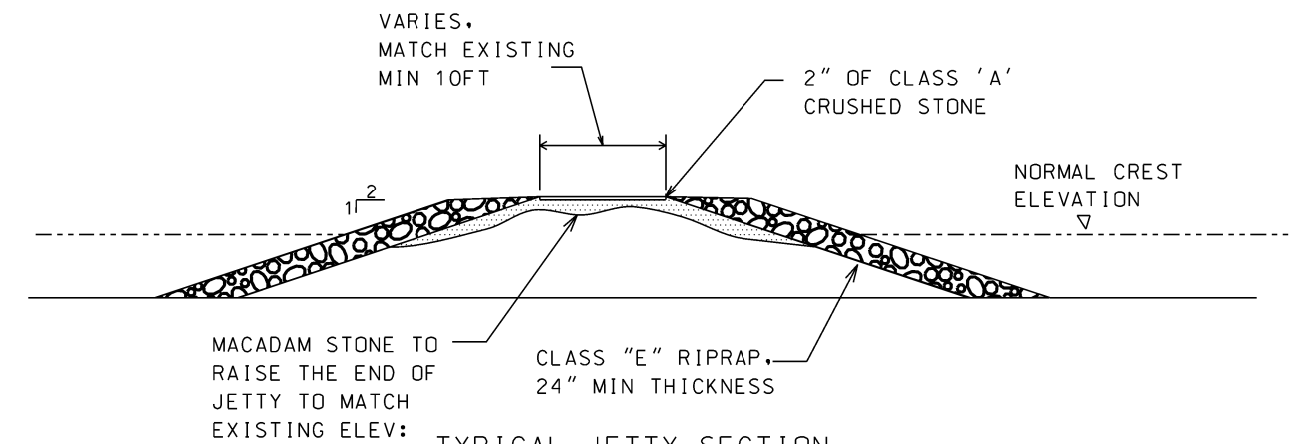

TYPICAL JETTY SECTION
NOT TO SCALE

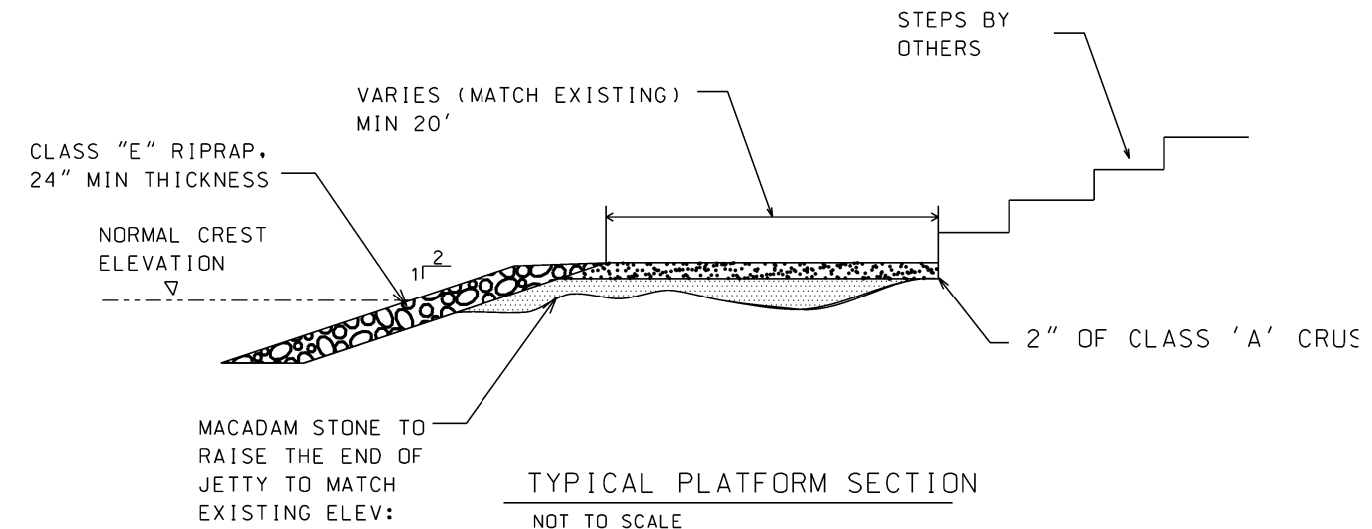

TYPICAL PLATFORM SECTION
NOT TO SCALE

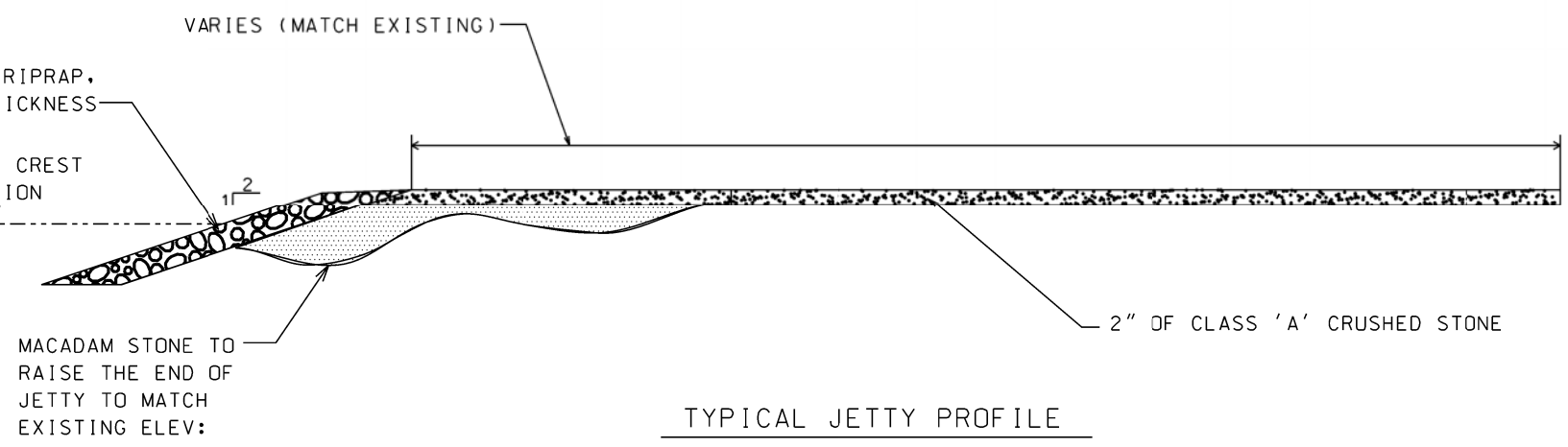

TYPICAL JETTY PROFILE
NOT TO SCALE

CONSULTANT:

IOWA DEPARTMENT OF NATURAL RESOURCES
 ENGINEERING SERVICES - WALLACE BUILDING
 502 E. 9TH ST., DES MOINES, IA 50319-0034



DETAILS

JETTY RESTORATION FOR:
BIG CREEK STATE PARK

POLK COUNTY, IA

NO.	BY	REVISION
DRAWN BY:	ES	PROJECT NUMBER: 18-02-77-01
CHKD BY:	HD	DATE: FEB/2018
SHEET No:	5	

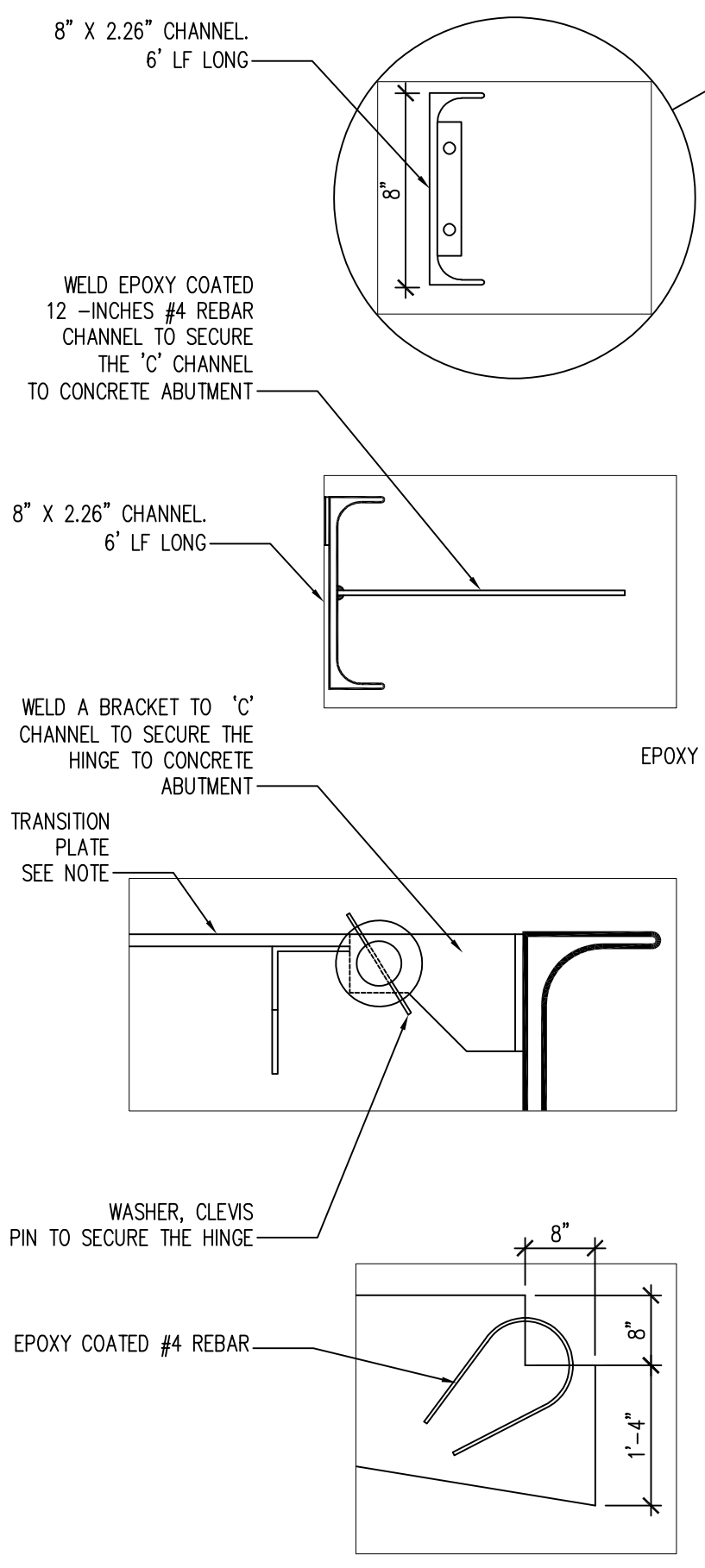

EPOXY COATED #4 REBAR
3 REQ'D

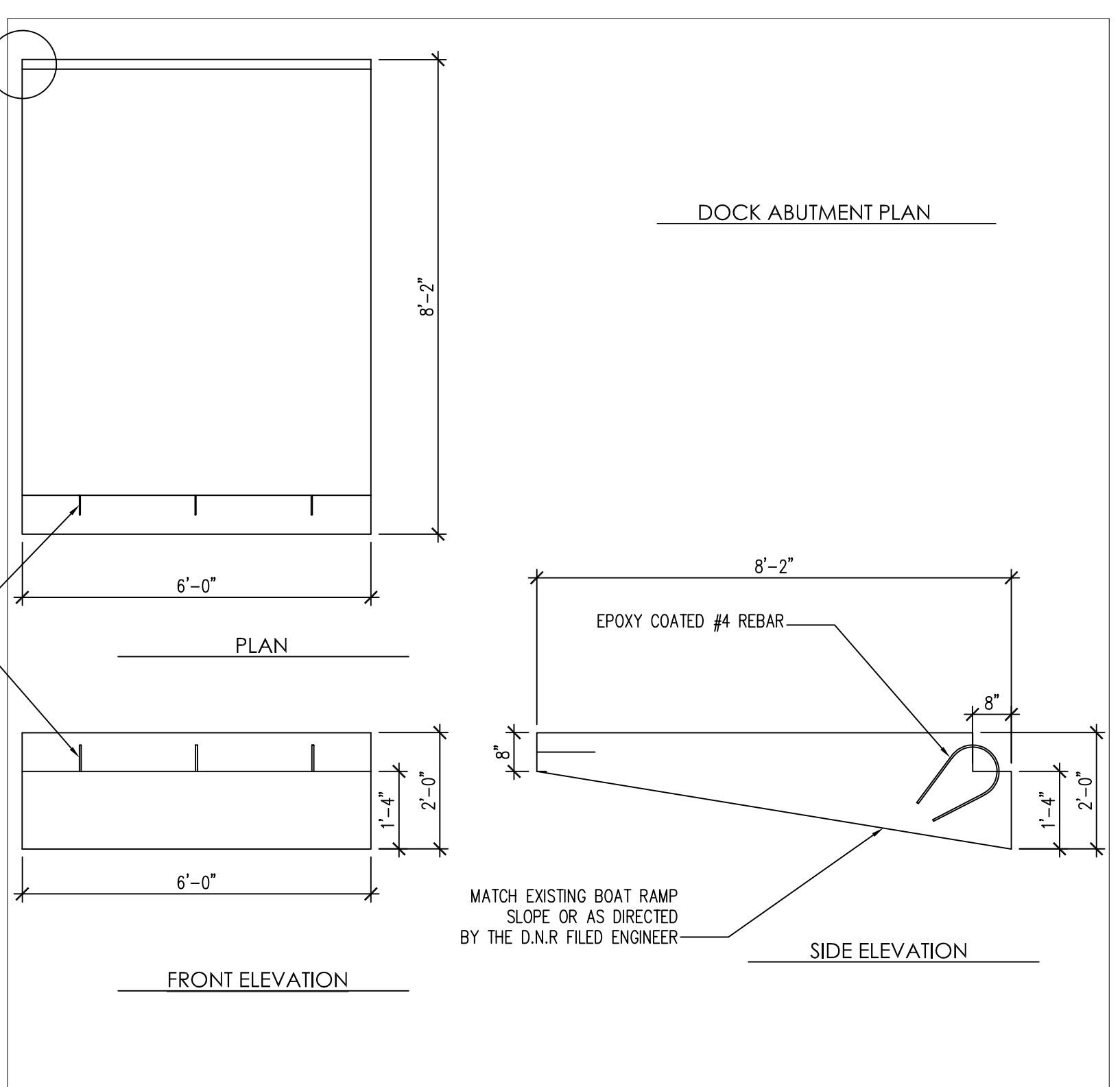

NOTE: DOCK FORMWORK
ONE FORM FOR DOCK ABUTMENT IS AVAILABLE AT THE PARK OFFICE AND
CONTRACTOR WILL BE RESPONSIBLE FOR REQUESTING, TRANSPORTING AND
RETURNING IT TO PARK OFFICE CLEAN. THE CONTRACTOR MAY CONSTRUCT
ADDITIONAL FORMS IF DESIRED

NOTE: TRANSITION PLATE
THE CONTRACTOR SHALL SUPPLY AND INSTALL 4' X 5' STEEL PLATE
(DIAMOND LUG PATTERN) OR APPROVED EQUAL BY THE D.N.R FIELD ENGINEER

CONSULTANT:

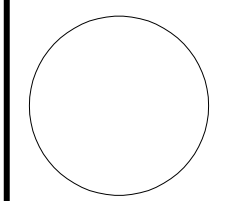

IOWA DEPARTMENT OF
NATURAL RESOURCES
ENGINEERING SERVICES - WALLACE BUILDING
502 E. 9TH ST., DES MOINES, IA 50319-0034



DOCKS ABUTMENTS DETAILS

BIG CREEK JETTIES REPAIR:

BIG CREEK STATE PARK

POLK COUNTY, IA

NO.	BY DATE	REVISION

DRAWN BY: PROJECT NUMBER:
ES 18-02-77-01

CHK'D BY: DATE:
DL FEB/2018

SHEET No:

TRANSITION PLATE



CONCRETE DOCK SIDE VIEW ELEVATION

NOT TO SCALE



CONCRETE DOCK FRONT VIEW ELEVATION

NOT TO SCALE

NOTE:
SEE SHEET 6 FOR DETAILS AND DIMENSIONS

CONSULTANT:

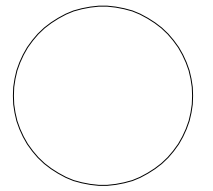

IOWA DEPARTMENT OF
NATURAL RESOURCES

ENGINEERING SERVICES - WALLACE BUILDING
502 E. 9TH ST., DES MOINES, IA 50319-0034



DOCKS ABUTMENTS DETAILS

BIG CREEK JETTIES REPAIR:

BIG CREEK STATE PARK

POLK COUNTY, IA

NO.	BY DATE	REVISION

DRAWN BY:	PROJECT NUMBER:
ES	18-02-77-01
CHEK'D BY:	DATE:
DL	FEB/2018

SHEET No: